



Claves.



Highgrove Close

Bolton, BL1 8QE

Offers around £80,000



This Two Bedroom apartment for over 55s nestled very conveniently on a quiet cul-de-sac in Astley Bridge is perfect if you are looking to put your own stamp on this cosy abode. 18 Highgrove Close holds with it a great opportunity to design your new home internally throughout and is priced accordingly. Despite the heaps of potential this property provides regarding modernisation, it is in perfect working order and is ready to move into.



A Quiet Cul-De-Sac Providing Peace of Mind

The property lies on a cul-de-sac built exclusively for over 55s, providing peace of mind that your street will remain in its current pleasant condition - quiet, well-presented, and overseen by a dedicated management company - allowing you to feel happy and secure within this close-knit community.

Everything You Need on Your Doorstep

Highgrove Close is a lovely development tucked away in a leafy position in Astley Bridge. Within a short walk's distance to the main bus route into Bolton, as well as supermarkets such as Asda and Lidl, and a wide variety of shops on Blackburn Road, you need not worry about accessibility... You have everything you need on your doorstep!

A Great Refurbishment Opportunity

With your entrance hall on the ground floor, this cosy and welcoming residence provides accommodation on the first floor, including a spacious lounge, kitchen, double bedroom with fitted wardrobes, a single bedroom, and a main three-piece shower room. One of the key attractions to this property is the opportunity to refurbish the interior to your exact preference, though it is fully functional and ready to move into, allowing you take it one room at a time if you so please. Alternatively, there's always the option to do all the work in one go before you move in... Imagine walking into your brand new apartment, with every inch of it designed by you!

Area Map



Floor Plans

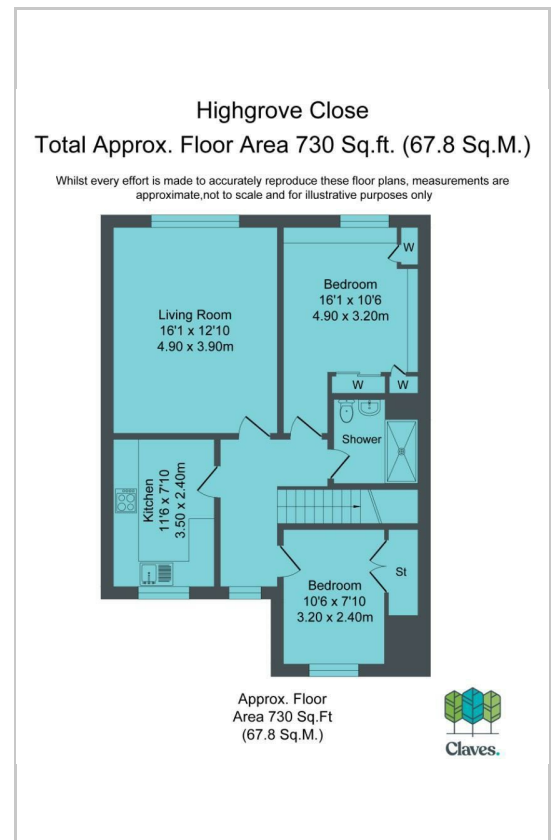

Energy Efficiency Graph

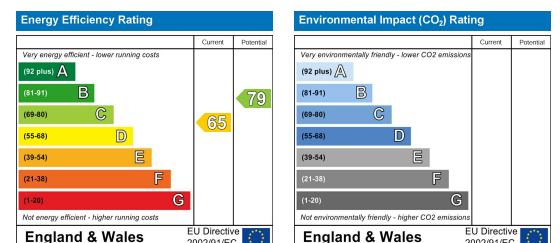

These particulars, whilst believed to be accurate are set out as a general outline only for guidance and do not constitute any part of an offer or contract. Intending purchasers should not rely on them as statements of representation of fact, but must satisfy themselves by inspection or otherwise as to their accuracy. No person in this firm's employment has the authority to make or give any representation or warranty in respect of the property.

Claves.

Claves House, 295D Darwen Road, Bromley Cross, BL7 9BT.
t. 01204 929 940 | e. info@claves.co.uk | w. claves.co.uk